

K4 Tank Washing Nozzle-19250

Design features

19250 Compact Nozzle can generate self-rotary drive for side spraying by two flat fan spray tip with 25 mm hole. The top hatch makes a whole global spraying available.

The main material is 316 stainless steel, while axletree and axletree circle are made of rigid stainless steel for longest wearability life.

The max. pressure is 13 bar and max temperature is 180 centigrade.

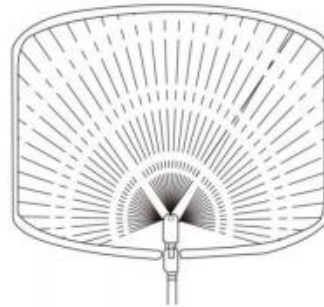
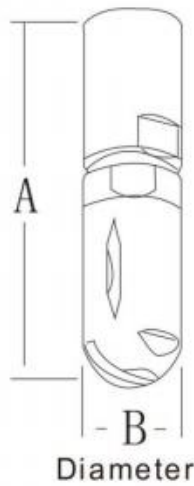

Performance data

Nozzle Order Number	Capacity (l/min.)							
	1.5Bar	3Bar	4Bar	5Bar	6Bar	8Bar	10Bar	12Bar
19250-STCN5-316SS	49	19.7	23	25	28	32	36	39
19250-STCN6-316SS	15.9	22	26	29	32	37	41	45
19250-STCN7-316SS	19.5	28	32	36	39	45	50	55
19250-STCN8-316SS	22	32	36	41	45	52	58	63
19250-STCN9-316SS	28	39	46	51	56	64	72	79

Size and weight

Nozzle Number	19250	A(mm)	89	B(mm)	25.4	Net Weight(KG)	0.23
---------------	-------	-------	----	-------	------	----------------	------